

Warmington Compact Studio Fire - Log Box

Warmington Compact Studio Fire.

Fire & Flue System to comply with AS/NZS 2918:2001.

Due to continued product improvement, Warmington Ind LTD reserves the right to change product specifications without prior notification.

Read all the Instructions carefully before commencing the Installation. Failure to follow these instructions may result in a fire hazard and void the warranty

For Specification See: www.warmington.co.nz

Copyright ©

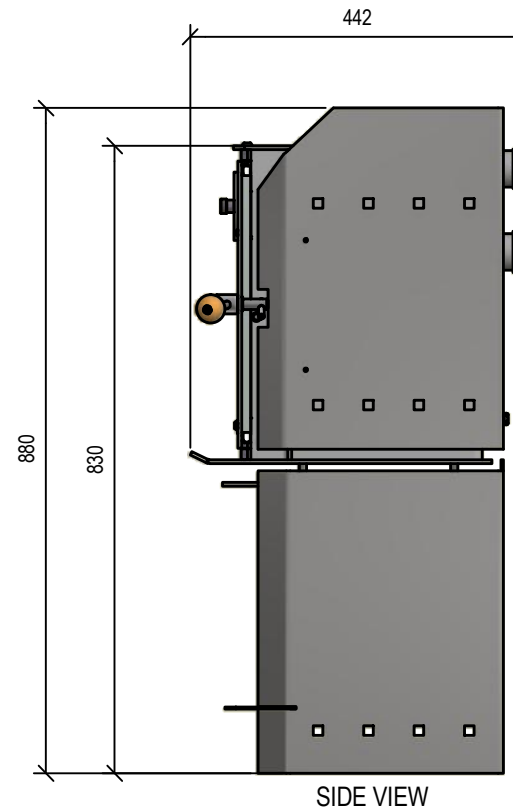

Warmington Industries Ltd. PH: 09 273 9227 FAX: 09 273 9241 WEB: www.warmington.co.nz			
TITLE	COMPACT STUDIO FIREBOX - LOG BOX		
DRAWN	EVEREST	DATE	29/03/21
SCALE	NOT TO SCALE	REVISION	01

Warmington Compact Studio Fire - Log Box

Straight Wall Installation.

SITUATION 1 - Combustible Clearances

Warmington 3.6m Freestanding Fluekit(1.2-2.4m Combo).

Fire & Flue System to comply with AS/NZS 2918:2001.

Due to continued product improvement, Warmington Ind LTD reserves the right to change product specifications without prior notification.

Read all the Instructions carefully before commencing the Installation. Failure to follow these instructions may result in a fire hazard and void the warranty

For Specification See: www.warmington.co.nz

Copyright ©

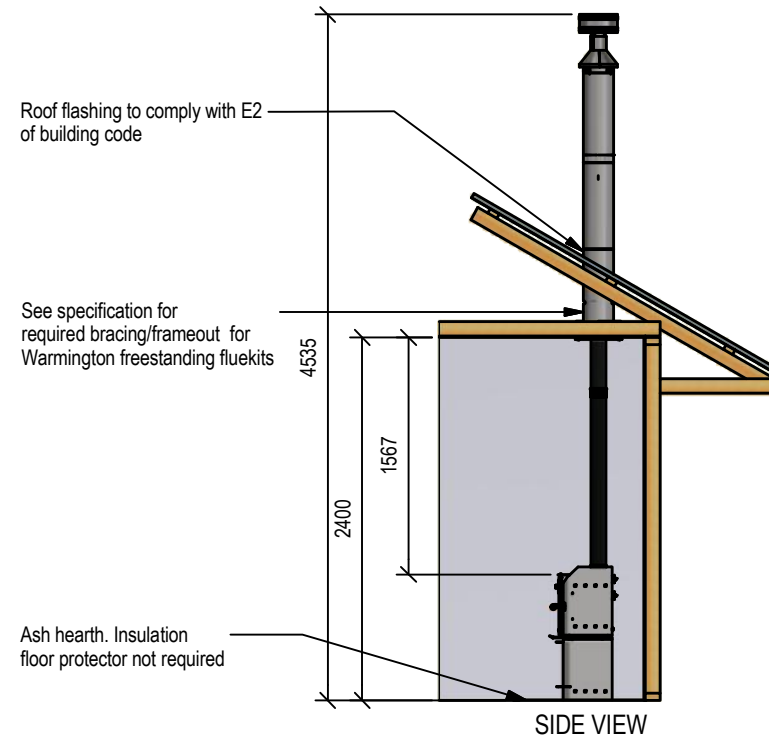
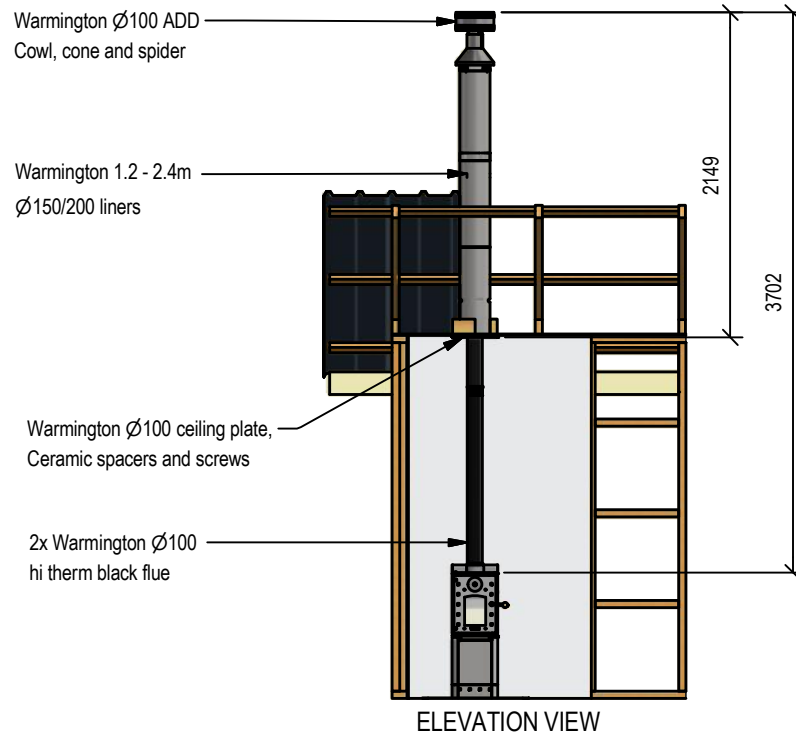
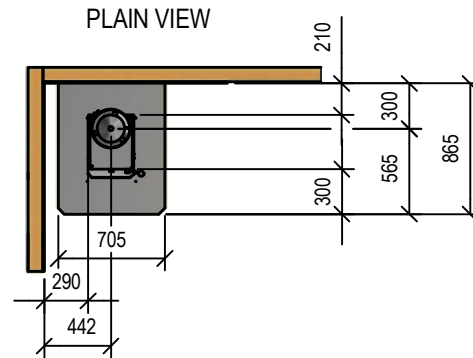

Warmington Industries Ltd. PH: 09 273 9227 FAX: 09 273 9241 WEB: www.warmington.co.nz			
TITLE COMPACT STUDIO FIRE - STRAIGHT INSTALLATION - SITUATION 1			
DRAWN EVEREST	DATE 30/03/21		REVISION 01
SCALE NOT TO SCALE			

Warmington Compact Studio Fire - Log Box

Straight Wall Installation.

SITUATION 2 - Non-Combustible Clearances

Warmington 3.6m Freestanding Fluekit(1.2-2.4m Combo).

Fire & Flue System to comply with AS/NZS 2918:2001.

Due to continued product improvement, Warmington Ind LTD reserves the right to change product specifications without prior notification.

Read all the Instructions carefully before commencing the Installation. Failure to follow these instructions may result in a fire hazard and void the warranty

For Specification See: www.warmington.co.nz

Copyright ©

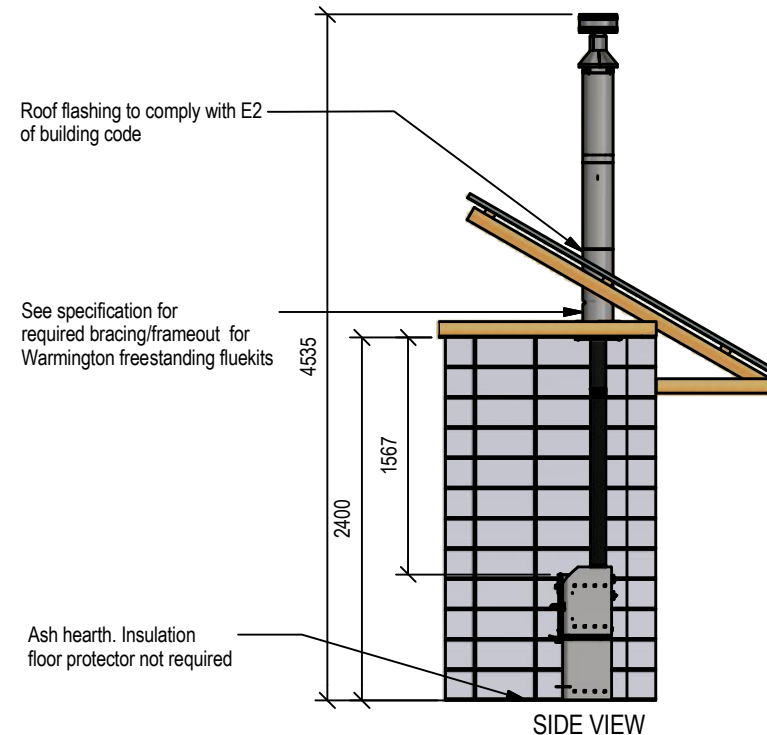
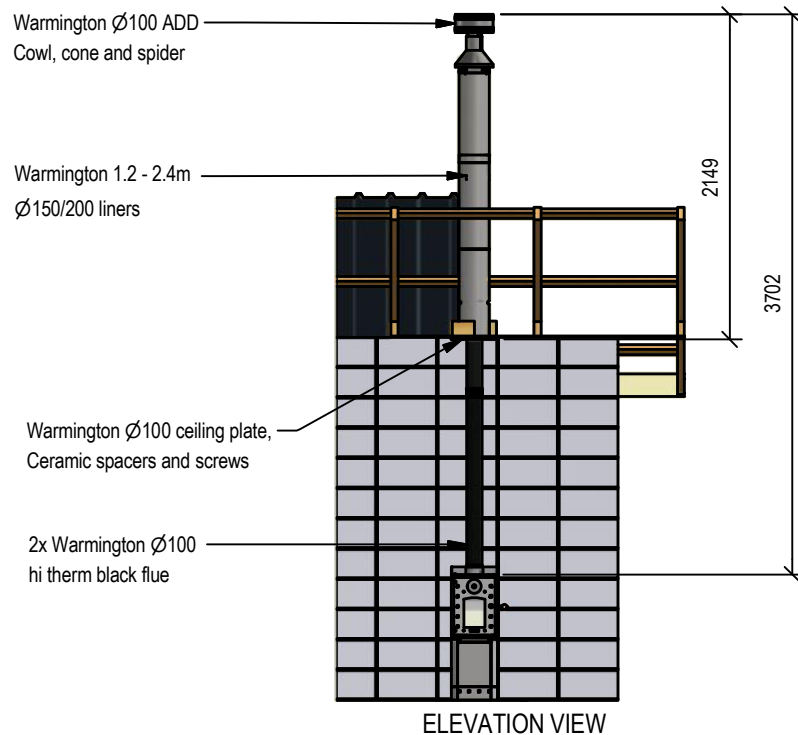
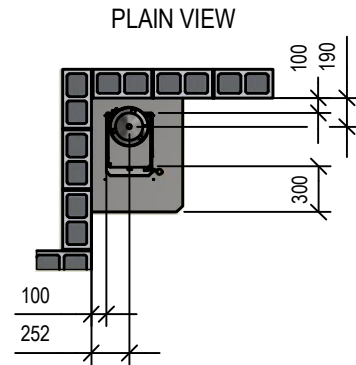

Warmington Industries Ltd. PH: 09 273 9227 FAX: 09 273 9241 WEB: www.warmington.co.nz			
TITLE COMPACT STUDIO FIRE - STRAIGHT INSTALLATION - SITUATION 2			
DRAWN	EVEREST	DATE	30/03/21
SCALE	NOT TO SCALE	REVISION	01

Warmington Compact Studio Fire - Log Box

Corner Installation.

SITUATION 1 - Combustible Clearances

Warmington 3.6m Freestanding Fluekit(1.2-2.4m Combo).

Fire & Flue System to comply with AS/NZS 2918:2001.

Due to continued product improvement, Warmington Ind LTD reserves the right to change product specifications without prior notification.

Read all the Instructions carefully before commencing the Installation. Failure to follow these instructions may result in a fire hazard and void the warranty

For Specification See: www.warmington.co.nz

Copyright ©

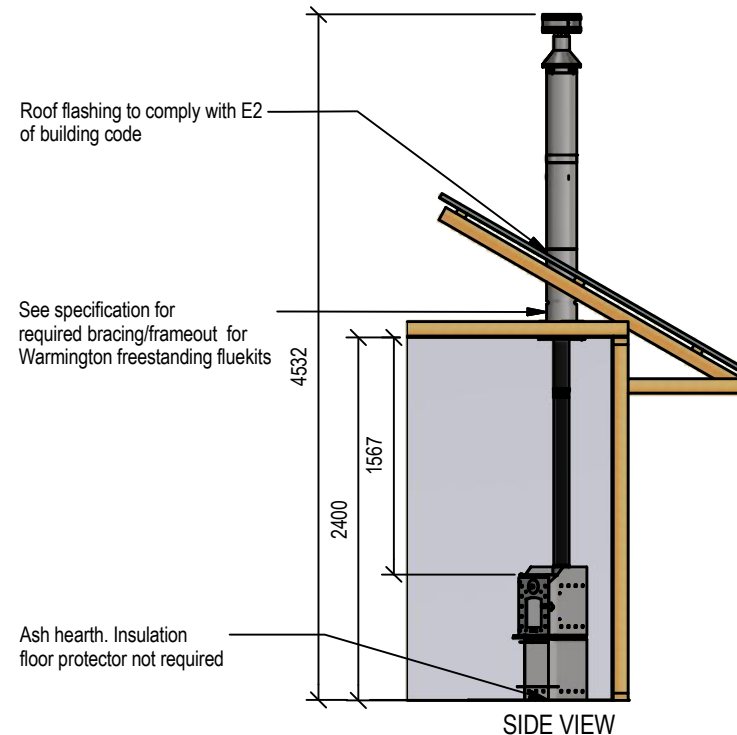
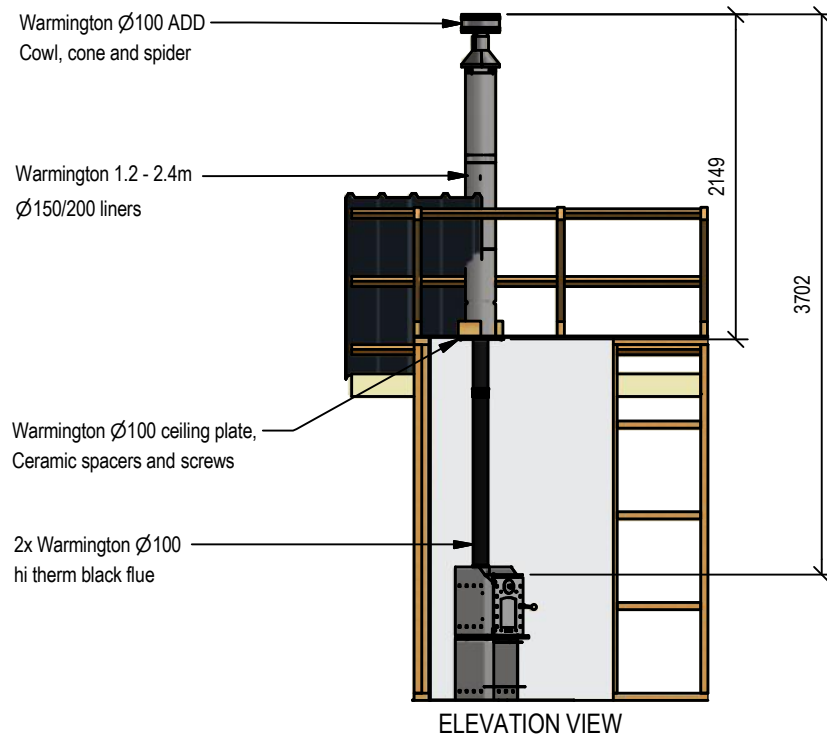
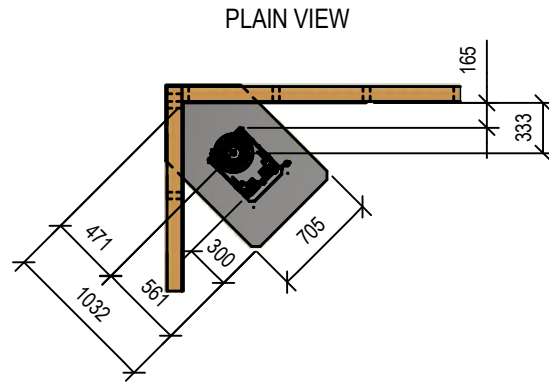

Warmington Industries Ltd. PH: 09 273 9227 FAX: 09 273 9241 WEB: www.warmington.co.nz		
TITLE COMPACT STUDIO FIRE - CORNER INSTALLATION - SITUATION 1		
DRAWN EVEREST	DATE 06/04/21	REVISION 01
SCALE NOT TO SCALE		

Warmington Compact Studio Fire - Log Box

Corner Installation.

SITUATION 2 - Non-Combustible Clearances

Warmington 3.6m Freestanding Fluekit(1.2-2.4m Combo).

Fire & Flue System to comply with AS/NZS 2918:2001.

Due to continued product improvement, Warmington Ind LTD reserves the right to change product specifications without prior notification.

Read all the Instructions carefully before commencing the Installation. Failure to follow these instructions may result in a fire hazard and void the warranty

For Specification See: www.warmington.co.nz

Copyright ©

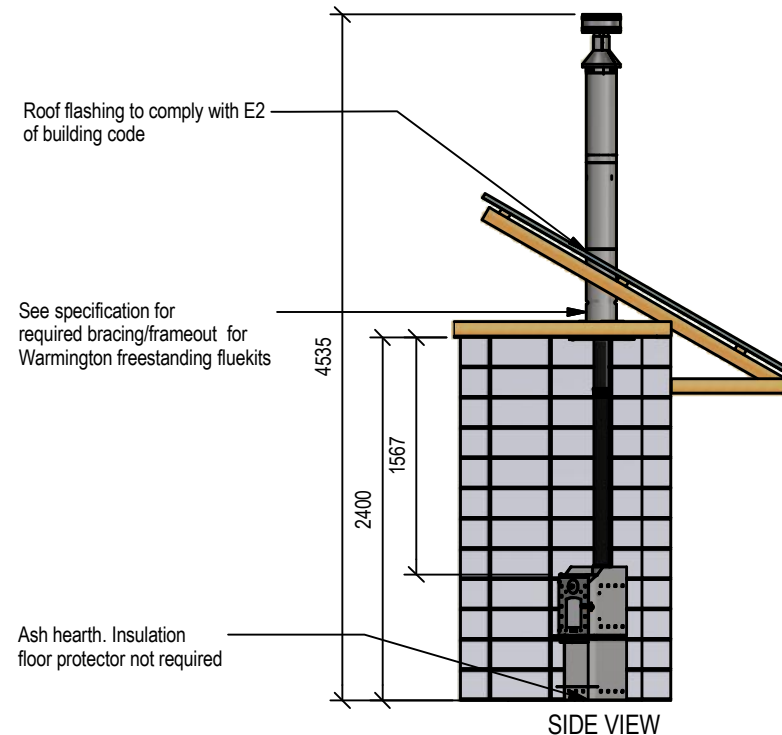
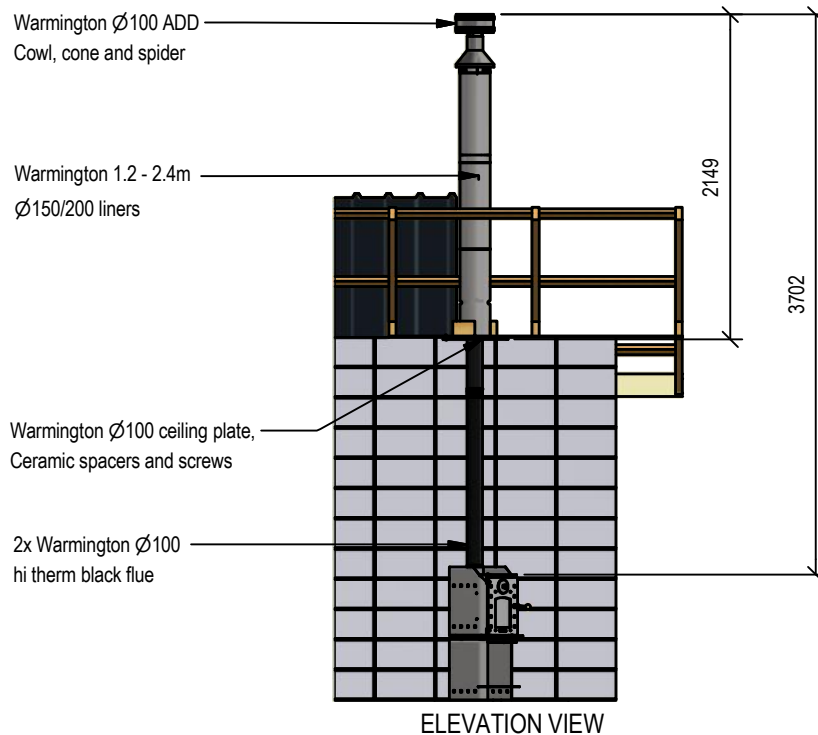
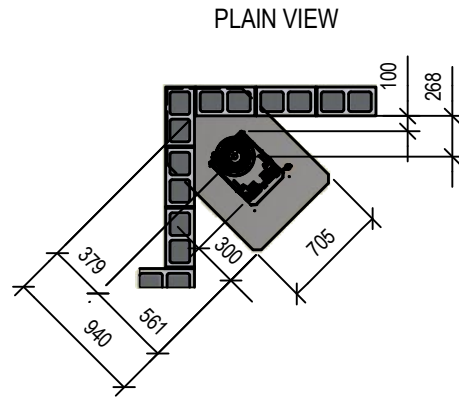

Warmington Industries Ltd.			
PH: 09 273 9227 FAX: 09 273 9241 WEB: www.warmington.co.nz			
TITLE COMPACT STUDIO FIRE - CORNER INSTALLATION - SITUATION 2			
DRAWN	EVEREST	DATE	30/03/21
SCALE	NOT TO SCALE	REVISION	01